

**NEW**

## **DuraFlex** Press Lock

Lid lock for the majority of  
500 to 1100l steel containers

- ✓ Easy to operate
- ✓ No messy assembly or fitting
- ✓ Fits any brand of container
- ✓ Outstanding value

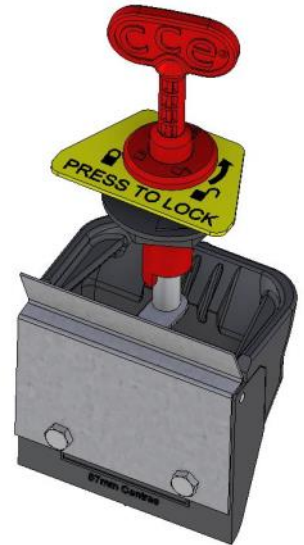

The **DuraFlex Press2Lock™** with its special security key has been designed and manufactured for recycling and trade waste containers alike

- to prevent scavengers & fly tipping,
- to prevent cross contamination of recyclables.

### **BENEFITS OF THE LOCK**

- ✓ **Easy to operate:** The lid can be locked without using a key simply by pressing, it clicks shut & locks.
- ✓ **Designed not to lock unintentionally when lid shuts by mistake** greatly reduces the risk of people or animals getting locked in the bin. *(This benefit excludes all recycling lids as they are intended to be kept locked.)*
- ✓ **Easy to fit & no messy assembly:** Simply drill two 7mm holes in container and affix base, fit lock upper part into lid as a normal lock fits and lock together, then align and fit hinge bar.
- ✓ **Our specially designed pentagon shaped key** for the DuraFlex Press2Lock™ will aid security and help prevent cross-contamination of recyclables.
- ✓ In contrast to other similar locks, the DuraFlex Press2Lock™ has a **quarter turn anti-clockwise mechanism like standard lid locks.**
- ✓ **The security key is in line with EN840 requirements** & is similar to the standard triangular key in design and with the 50mm length allows safe operating when wearing gloves.
- ✓ **Incorporates an instruction plate that glows in the dark** and helps users at night.
- ✓ **The DuraFlex Press2Lock™ and the key are coloured red to distinguish them from standard locks.**
- ✓ **Completely maintenance free, no greasing.**

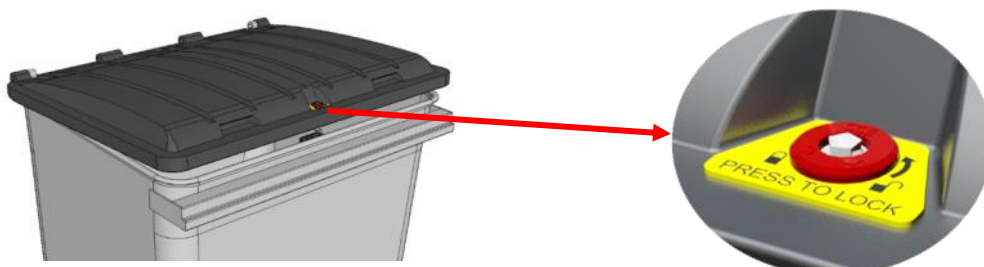

The **DuraFlex** <sup>Press</sup> <sub>Lock</sub> has been designed to fit any brand of steel container, without having to work to unobtainable tolerances, or having to buy new lids or new containers.

We recommend using the lock with our DuraFlex lids & hinge brackets. However, it can be used successfully with other leading brands of lids.

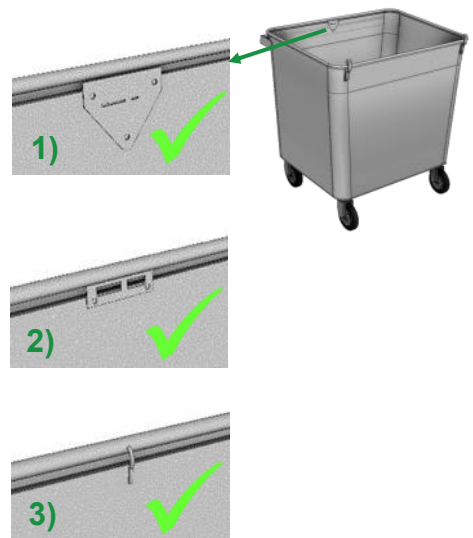

\* Please note: if your bin has a latch plate or a hook as shown on fig. 2 & 3, these need to be removed before you can fit the lock.

### Press2Lock kit contents:

- 1) Lock assembly & nut
- 2) Key \*
- 3) Luminous instruction plate
- 4) Lock base assembly
- 5) Cover plate
- 6) 2 bolts, 2 nuts & 4 washers
- 7) Guide plate

\* Additional keys are available.

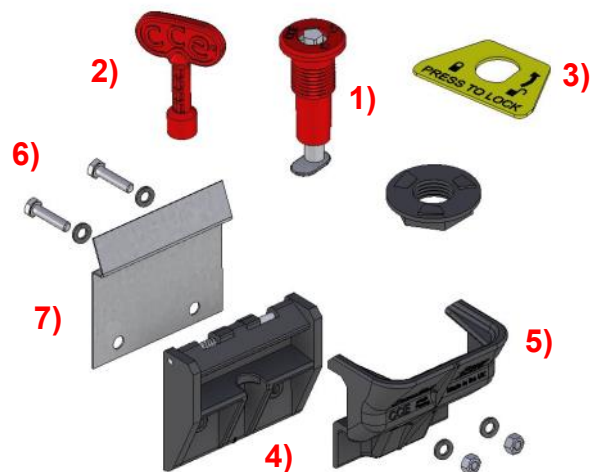

The guide plate should be fitted to all brands of steel container.

The guide plate will

- protect the lock from damage,
- add extra guide control for the pawl on entry, and
- prevent the lock in the lid from resting, or fouling, on the back of the lock body if not fitted correctly.

## RELATED PRODUCTS

Our double-walled, high quality DuraFlex® trade waste lids:

- For 500 up to 1100 l containers,
  - For all known UK brands & manufacturers.
- Metal hinge brackets for trade waste lids
  - Metal hinge bar for trade waste lids



enq@duraflexlids.co.uk — Phone: 0044 (0)1246 853696  
www.containercomponents.co.uk

